

H-60 corrugated Steel Bulkhead

non-load bearing

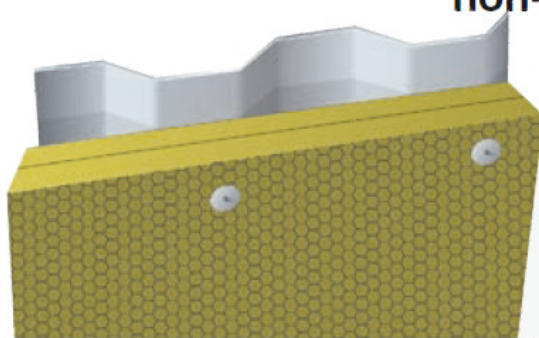

Product: Rockwool HC Firebatts 150
Rockwool HC Wired Mat 150

Density: 150 kg/m³

Thickness: Plate 50 mm + 40 mm insulation

Construction:

- Corrugated steel plate insulated with 50 mm Rockwool HC Firebatts 150 and 40 mm Rockwool HC Wired Mat 150.
- Corrugated steel plate of min. 1.5 mm.
- $\varnothing 3$ mm pins fixed with approx 300 mm distance.
- Pins fixed on top of corrugated steel plate by washers of $\varnothing 38$ mm
- No fill of corrugation

Application notes:

- All the connections must be tight, no air gaps.
- Joints must be staggered, 150 mm overlap is recommended.
- The pins should exceed the insulation by approx 10 mm
- Wire mesh twisted together of joints.
- Same solution as H-120.

Advantages:



Safe solution



Optimal sound properties



Fast installation

Surfaces:

- Reinforced aluminium foil

